



NEWSLETTER

June 2019

WELCOME

Welcome back! We hope you had a wonderful half term break. We have a fantastic half term planned for the children.

We have a very busy time ahead of us so please read through this information carefully, and keep an eye on our notice boards, website, Facebook and Twitter too for up to date information.

DATES TO REMEMBER

<i>First day of 2nd Half term</i>	<i>Monday 3rd June</i>
<i>Photographer for group photos</i>	<i>Monday 24th June</i>
<i>Leavers Service</i>	<i>Friday 19th July</i>
<i>Teddy Bear's Picnic</i>	<i>Friday 19th July</i>
<i>Last Day of Summer Term</i>	<i>Friday 19th July</i>
<i>First day of Autumn Term</i>	<i>Wednesday 4th September</i>

CHANGE OF TRUSTEES

Nicole Poole has stepped down as a nursery trustee. We would like to say a huge thank you to Nicole for many years of hard work as a trustee and latterly as Vice Chair.

Natalie Saunders our treasurer is also stepping down at the end of the financial year. Natalie has put in countless hours and late nights over many years as our treasurer. We would like to thank her for all the hard work and spreadsheets!

We have 3 new trustees to introduce to you:

Lucy Clements (one of our nursery parents) as our new treasurer. Natalie will be working closely with Lucy in the coming months to hand over.

Jo Atkinson (one of our nursery parents) will be the trustee responsible for the building, gardens and health and safety.

Paul Amphlett will be the trustee responsible for HR and staff, and Sue's direct line manager. We would like to welcome them all to the team.

FEE INCREASE

Please note that as of September 2019 there will be an increase to our fees:

8.45am - 11.45am £16.80

11.45am - 2.45pm £16.80

8.45am - 2.45pm £33.60

Should you have any queries regarding your fees, funding or sessions please speak to Laura in the Nursery Office.

WRAP AROUND CARE

We are excited to announce that from September we will be offering wrap around care in the form of a breakfast club and after nursery club:

8.15am – 8.45am £3.00 (includes breakfast)

2.45pm – 4.30pm £10.50 (includes a light tea)

2.45pm – 5.30pm £16.50 (includes a light tea)

Further details of how to book will be available shortly.

NURSERY GARDEN

We are really excited that phase one of our garden landscaping will be beginning on 17th June. We have been busy fundraising, and gained a community grant from Surrey Heath Borough Council which has allowed us to begin. Infinite Playgrounds will spend a week transforming the centre of our garden into an exciting, green play space complete with hills, tunnels, bridge, slide and shade. If you would like to see the full plans please pop into the Nursery Office where we will be happy to show you.

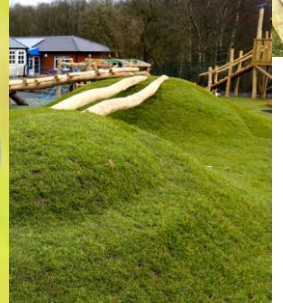
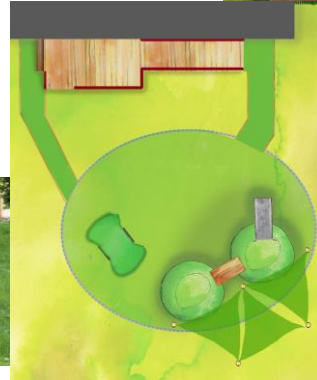

SUMMER TEDDY BEAR'S PICNIC 19th July

We are really excited to be having a Teddy Bear's Picnic in our Nursery garden with all our families to celebrate the end of term. More information to follow shortly. Please save the date.



NURSERY TEA TOWEL

The children have been busy drawing a self-portrait each to be put on our nursery tea towels. These will be available to buy shortly and any money raised will go towards our nursery garden. Thank you for your support.



SUMMER WEATHER

When our summer weather finally arrives, please can we remind you that it is very important that you apply sun cream to your child before they come to nursery, and send them with a named sun hat to wear when playing in our garden. Please also avoid open-toed / flip-flop shoes.

NEXT STEPS



We hope you enjoy reading the weekly activities updates, if you would like more detailed information about your child's learning and development please check out Tapestry where you can find photographs and observations. You can also pop into the nursery and speak to your key worker or look at the footprints on the window to see your child's next steps detailed.

TOTS AND DOTS

You may not be aware that St Mary's Church has a toddler group that meets on Monday mornings from 9.30am. Tots and Dots is a friendly and welcoming playgroup for under 5's and their parents or carers. If you have younger children not yet at Nursery, why not pop along after drop off and join them for toys, drinks, snacks and crafts? Entrance £1 per family.





OASIS COFFEE STOP

On Thursday mornings in term time, join other busy mums/dads/carers for coffee, tea, cake, and toast in the lounge at St Mary's Church. Why not take the time to relax, chat and chill out after the busy school run.

WATER BOTTLES & NUT FREE AREA

We would like to thank you for your cooperation in helping us meet an Ofsted requirement by only supplying water in the children's drink bottles. Your support has also been very much appreciated in keeping the nursery a nut free area as we have a severe nut allergy in the nursery.



HEALTHY LUNCHES

We would like to remind you to pack a healthy lunch for your child and keep the chocolate and sweets at home for a special treat. If you need any advice on what to include in a well balanced packed lunch please speak to Sue or Louise and they will be able to give you a leaflet with some suggestions.

SNACK TIME

We value your contribution of one piece of fruit per week, per child. As you know, this is an essential part of a healthy diet and your children enjoy eating the fruit you supply.

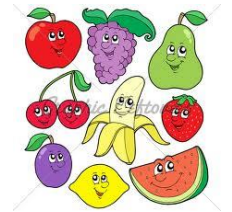

FACEBOOK, TWITTER AND WEBSITE

We have a Facebook page and twitter account in addition to our website. You can find us here:

www.facebook.com/stmarysnurserycamberley

Please 'like' our page! It will be regularly updated with photos, info and news, or on:

Twitter: @nurserymarys

www.stmarysnurserycamberley.co.uk



USEFUL INFORMATION

St Mary's Nursery Phone: **01276 581309**

St. Mary's Nursery Registration number **EY556342**

Surrey Family Information Service **0300 200 1004**

The Orchard Children's Centre **01276 691018**

Ofsted **0300 123 1231**

Registered Charity Number **1168824**

Here at St Mary's we take Safeguarding very seriously, please see our Safeguarding contacts:

Designated Safeguarding Lead – Louise Hughes Deputy Manager 01276 581309

manager@stmarysnurserycamberley.co.uk

Deputy Designated Safeguarding Lead – Sue Gauntlett Nursery Manager 01276 581309

Trustee Designated Safeguarding Lead – Rev Andrew Knowles 01276 581309

chair@stmarysnurserycamberley.co.uk

SENCO – Julie Gatenby 01276 581309 email c/o manager@stmarysnurserycamberley.co.uk

Deputy SENCO – Sylvanna Murphy 01276 581309 email c/o manager@stmarysnurserycamberley.co.uk

Multi-Agency Safeguarding Hub (MASH) – 0300 470 9100 or 999(if emergency)

Ofsted 0300 123 4666

NSPCC – 0808 800 5000

LADO (Local Authority Designated Officer) 0300 123 1650

Whistleblowing 0300123 3155

Children's Rights and Advocacy Team – Surrey Early Years – childrens.rights@surreycc.gov.uk